



JAYPEE
HOTELS & RESORTS
Agra • Greater Noida • Mussoorie • New Delhi



Jaypee Vasant Continental, New Delhi



Jaypee Siddharth, New Delhi



Jaypee Residency Manor, Mussoorie



Jaypee Greens Golf & Spa Resort, Greater Noida

Jaypee Hotels, JA Annexe, 54, Basant Lok,
Vasant Vihar, New Delhi 110057, India
Tel : +91-11-26148800 | sales@jaypeehotels.com
Toll Free: 1800 11 9900



JAYPEE PALACE
HOTEL & CONVENTION CENTRE

Fatehabad Road, Agra - 282004
reservations.jpa@jaypeehotels.com

Dwell in the Mughal Opulence

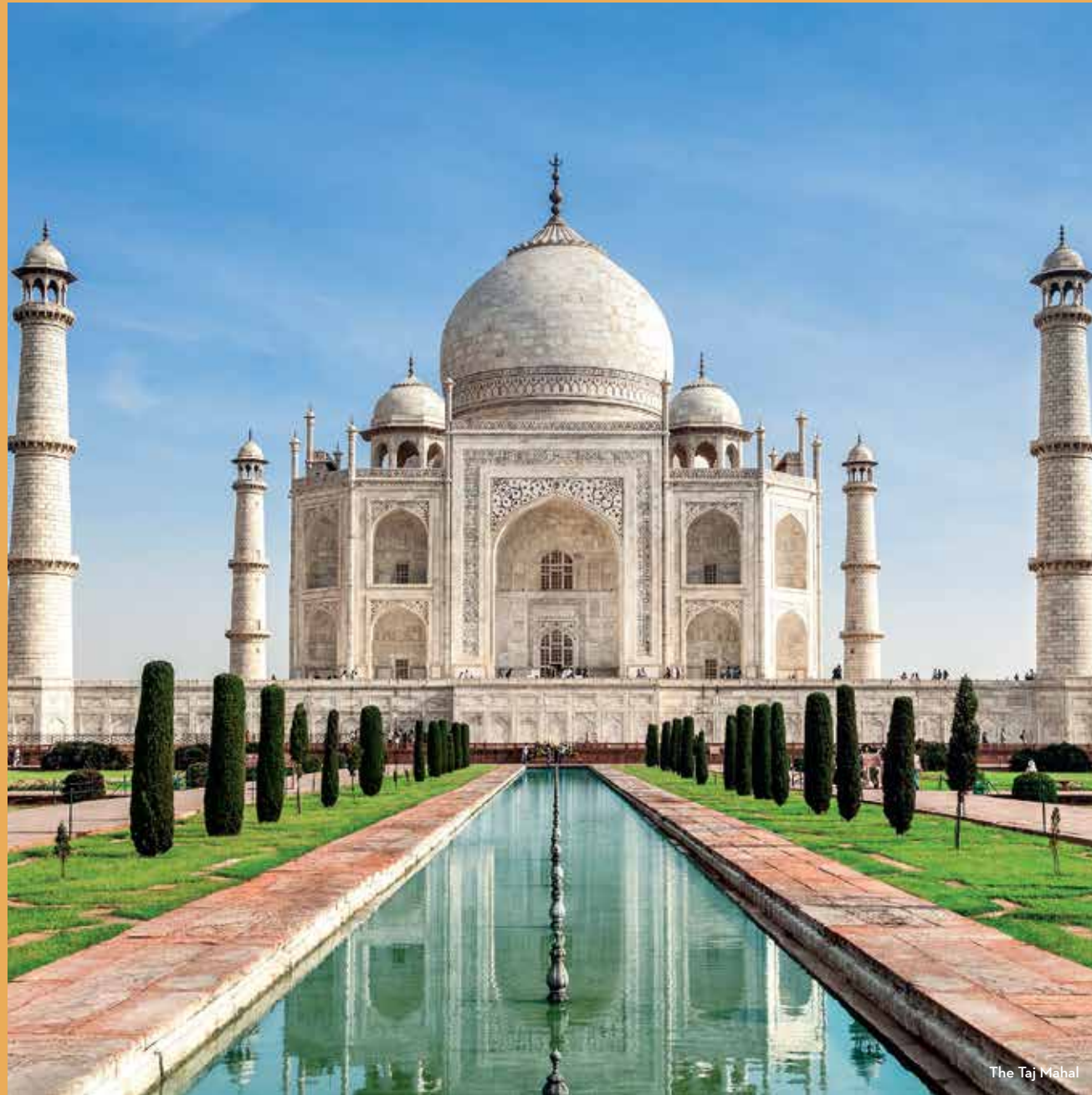

The Taj Mahal is an ivory-white mausoleum standing majestically on the banks of the Yamuna River, a symbol of love since the Mughal era. Indulge in the grace of perfection at this landmark of affection whilst you stay at **Jaypee Palace Hotel, Agra.**

With the grandeur of Jaypee Palace Hotel



Jaypee Palace Hotel & Convention Centre spreads over an expanse of 25 acres, is a sight to behold. Landscaped gardens, water bodies and pergolas make it a truly majestic experience in the city of love.

JAYPEE PALACE

HOTEL & CONVENTION CENTRE

The regal Jaypee Palace Hotel and Convention Centre, sprawled over an unbounded 25 acres of elegantly landscaped luxuriant greenery.

Sprinkled with enormous water bodies and endless walkways, this magical creation impeccably blends Mughal and contemporary architecture with modern amenities. Leading the way to luxurious rooms and suites, the impressive interiors set the tone for a majestic look.

Jaypee Palace Hotel, Agra, built of red sand stone and white marble is a tribute to the Mughal architecture. It is a perfect wedding destination offering grand banquet facilities in the City of Love, Agra.

The Hotel is an iconic property located in the heart of Agra and is a perfect blend of old world elegance and contemporary luxury, with the city's bustling commercial and historical centres just a few steps away.



Mughal Court

The hotel offers exquisitely appointed 341 rooms and suites, an array of dining options and dedicated leisure and business facilities - an ideal destination for the discerning traveler. Jaypee Palace Hotel is 2 hours from Delhi by Train as well as from Yamuna Expressway. Being located 12.4 kms from Kheria (Agra) Airport and 8 kms from Agra Cantt Railway Station, this meticulously designed masterpiece provides wide scope for all the travelers and vacationers to find refuge in its tranquil and serene ambience.

We welcome you to experience luxury served with warmth and care.

Perfect Stay

The hotel offers you to choose from a choice of 341 rooms and suites ranging from spacious executive rooms to Presidential suite - with private entrance and a helipad facility. The rooms are spacious and full of splendor, keeping the artistic legacy of the Mughal Dynasty alive.



Guest Room



Presidential Suite



Living Room - Presidential Suite

Guest Room Facilities

- Wi-Fi
- Centrally air-conditioned
- Individual Safe
- Iron/ Iron Board
- Tea/coffee maker
- Mini bar
- Valet



Reflection Pool



Solarium - The Grand Buffet



C'est Chine



The Tea Lounge

The Dining Experience

Jaypee Palace Hotel, Agra offers an eclectic mix of Indian and International cuisines. It houses some of Agra's best specialty restaurants and a bar that delights and presents international service standards with world class chefs.

THE GRAND BUFFET

The Grand Buffet, a multicuisine restaurant, offers an elaborate spread of soups, salads, main courses and desserts that make for a perfect place to indulge at

Timings:

Breakfast: 07:00am to 10:00am

Lunch: 12:30pm to 03:00pm

Dinner: 07:30pm to 11:00pm

THE tea LOUNGE

Tea Lounge's majestic interiors, overlooking stately gardens and water-bodies provide the perfect setting for a cup of choicest teas brewed to perfection, accompanied by delectable savouries

Timings: 11:00 am to 08:00 pm



Paatra



C'est Chine, open for lunch and dinner, serves authentic Chinese cuisine. Spices and ingredients are carefully handpicked by our chefs so that all the guests can enjoy the best flavors of their lives

Timings:

Lunch: 12 Noon to 3pm & Dinner: 7:30pm to 11:30pm



Paatra, the fine-dining restaurant at Jaypee Palace Hotel, Agra takes you on a culinary journey to various regions of India. Different 'paatras' or utensils determine the unique cooking methods that conserve the unique flavor of your food

Timings:

Dinner: 07:30 pm to 11:00 pm



Tapas, the stylish and elegant Lounge bar offers the finest spirits and wines along with a range of stimulating cocktails and appetizing snacks

Timings: 12 Noon to midnight



Diwane-e-Khaas



Wedding Setup



Board Room

Meticulous Meetings

In a historical setting, Jaypee Palace Hotel & Convention Centre, brings to you the finest facilities for meetings & conferences with state-of-the-art advanced technical set-ups, along with impeccable services making every business meeting a success.

The Convention Centre is built to exacting international standards and is backed by state-of-the-art conferencing facilities. The three times in a row National Tourism Award Winner of 'Best Hotel Based Meeting Venue', the convention hall has a built-in stage, green room, an exceptionally large pre-function area and a seating capacity of 1500 people in theatre style. It is one of the biggest facilities in this part of the country. Moreover, it is flexible enough to customize a combination of meeting and exhibition areas. At any given time, 8 simultaneous sessions can be held with a seating capacity of 150-300 persons.

The elegant Business Centre is expansive and uncluttered, creating a professional yet relaxed environment for delegates. It has Board Rooms, Meeting Rooms and Cabins with a Secretarial cum Reception Desk & other facilities like Computers/ Laptops, Internet, Photocopier, Facsimile, Telex, and other services. Complementing facilities include multilingual simultaneous interpretations, satellite uplinks, Hotline terminals, Audio-Visual recording & editing facilities and External Broadcasting Room.

Royal Weddings

The ultimate symbol of Love - the Taj Mahal is the source of inspiration at the Jaypee Palace Hotel, Agra, where every ritual is treated with care and is grand in its scale, similar to the Mughal Era.

Once you step into the hotel, you will be transported to an era that's timeless, with landscaped gardens, tree lined walkways, resplendent water bodies, dancing fountains and 341 luxurious rooms that blend modern day five star comforts with the Mughal opulence.

The trademark warmth and hospitality is reflected in our personalized wedding management ensuring that every little detail, however small, is given the attention it deserves.

Jaypee Palace Hotel, Agra is an ideal location for all wedding ceremonies with graceful indoor venues like Diwan-e-Khas, Diwan-e-Aam and Pavilions which can host upto 1000 guests at a time; is a perfect venue for cocktail dinners and receptions with an extension of open air premises like Exhibition Court, Banquet Court and lush green Pool side lawn. Capture the unforgettable moments of your lives at impeccably landscaped areas like Swiss Hills and Tennis Court which can accommodate 300 to 2000 people at a time.



Wedding Setup

Seating Capacity

Room	Level	Cluster	Theatre Style	Class Rooms	U Shape	DBL U-Shape	Board Room/ Hollow Block	Reception	Buffet cum Sit down
Convention Hall	ground	550	1500	615	150	275	150	2000	600
Banquet Hall	ground	140	350	230	100	150	100	500	150
Pool View Pavilion	second floor	60	125	50	45	75	56	150	84
Pavilion Heights	second floor	50	125	50	45	75	56	150	84
Pavilion of China	second floor	60	125	50	45	75	56	150	84
Board Room	first floor	-	-	-	-	-	25	-	-
Meeting Room No. 1	first floor	-	-	-	-	-	12	-	-
Meeting Room No. 2	first floor	-	-	-	-	-	12	-	-
Meeting Room No. 3	first floor	-	-	-	-	-	12	-	-
Meeting Room No. 4	first floor	-	-	-	-	-	12	-	-

Outdoor Venues

Lawn Tennis Court - 1000 persons
 Pool Side Lawns - 2000 persons
 Reflecting Court A - 300 persons

Banquet Court - 200 persons
 Exhibition Court - 300 persons
 Reflecting Court B - 300 persons

Combined Floor Plan

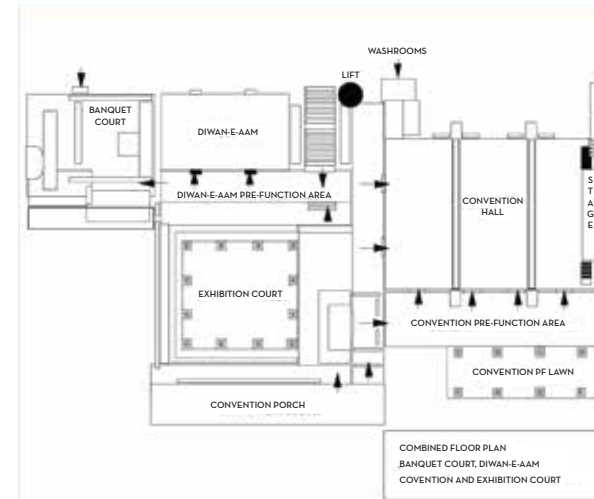

Diwan-e-Aam

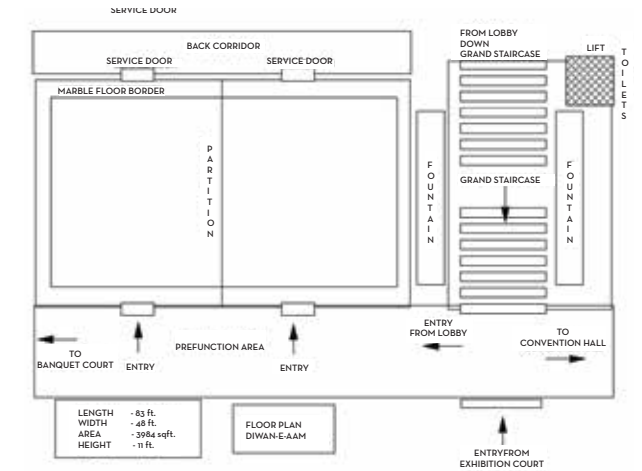

Technical Information

Room	Level	Area in Sq. Ft.	Area in Sq. Mtrs.	Dimension in Mtrs.	Exhibition Facility	Simultaneous Interpretation	Microphones	Recording Facilities	Projection Facilities
Convention Hall	ground	12,500	1,165	26.5*42.2+178*3.5	Y	Y	Y	Y	Y
Banquet Hall	ground	4,280	400	26.15 * 15.2	Y	N	Y	Y	Y
Pool View Pavilion	second floor	2,250	220	15 * 15	Y	N	Y	Y	Y
Pavilion Heights	second floor	1,910	180	15 * 12.5	Y	N	Y	Y	Y
Pavilion of China	second floor	2,250	220	15 * 15	Y	N	Y	Y	Y
Tennis Court	ground	22,500	2,150	26.2 in radius	Y	N	Y	Y	Y
Board Room	first floor	680	65	12.5 * 5.2	N	N	Y	Y	Y
Meeting Room No. 1	first floor	230	22	5 * 4.5	N	N	Y	Y	Y
Meeting Room No. 2	first floor	230	22	5 * 4.5	N	N	Y	Y	Y
Meeting Room No. 3	first floor	230	22	5 * 4.5	N	N	Y	Y	Y
Meeting Room No. 4	first floor	230	22	5 * 4.5	N	N	Y	Y	Y

Diwan - e - Khas Floor Plan

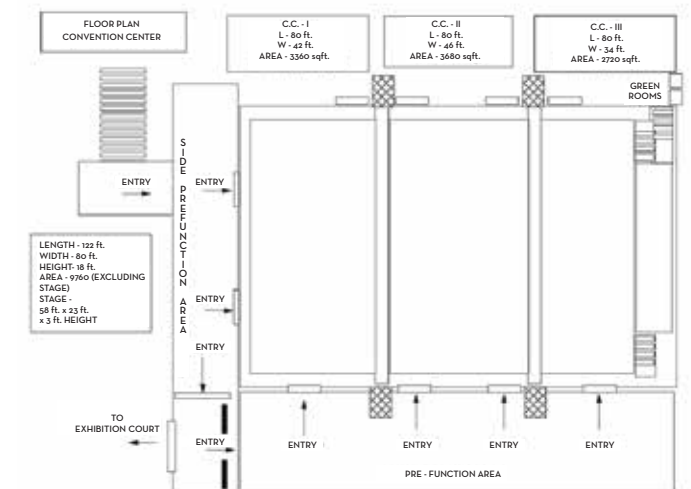
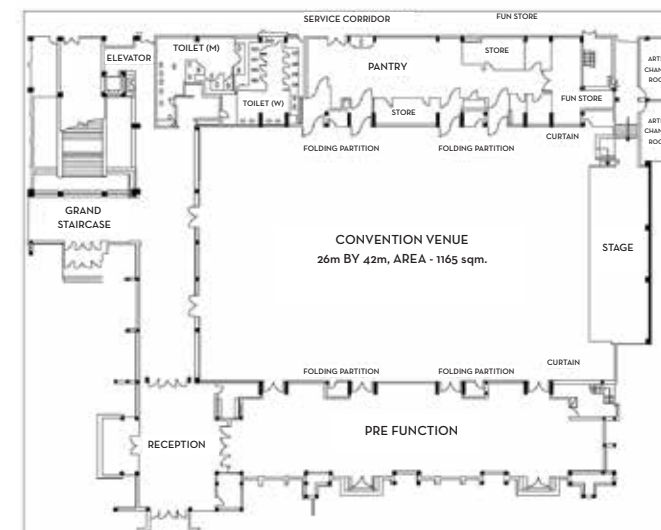

Business Centre

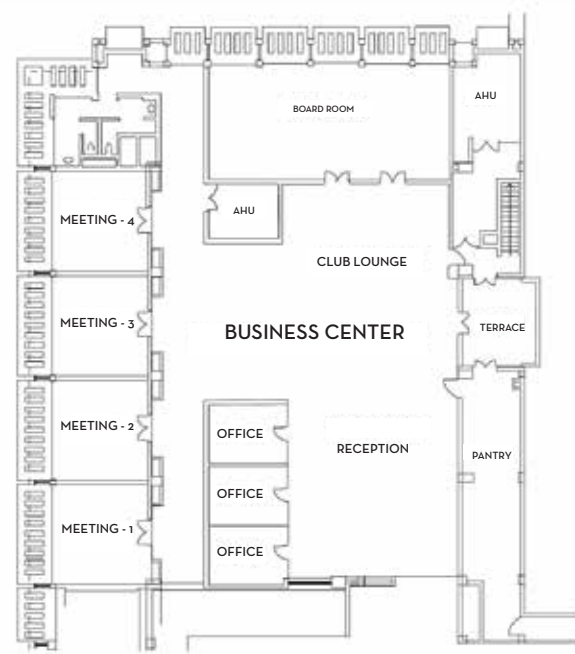

Pool Side Lawns

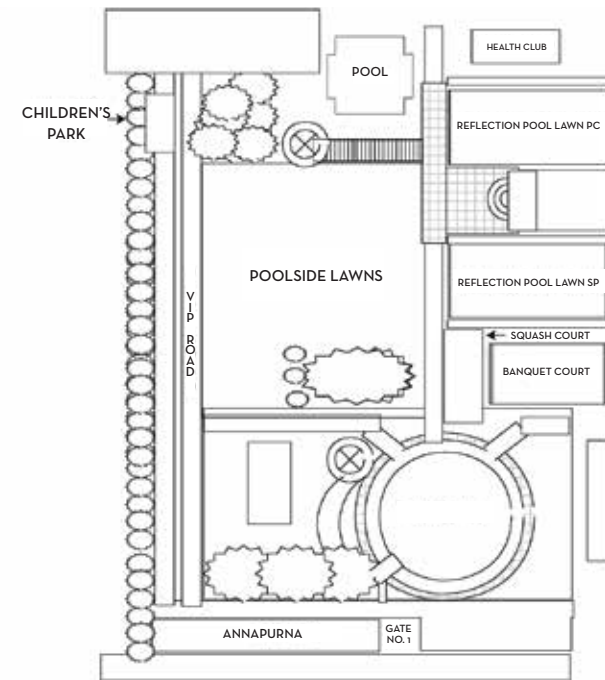

Tamaya Spa

Spa Service

Leisure & Recreation

Spread over a vast expanse, enjoy a good workout at the gymnasium or relax with a wide selection of therapies & services at the beauty salon. Dip into the pool, jog around the park, play squash, video games, go bowling, do guided yoga at The Swiss Hills or simply dance the night away at the discotheque.

Relieve stress, rejuvenate your body & soul at Tamaya - Spa, Salon & Wellness centre.

The exotic spa and salon services can't go unmarked once you encroach upon the periphery of this luxury deluxe hotel.

Providing you with the best of every service, this lavish creation leaves no stone unturned in order to make your visit memorable.

Apart from offering the stupendous stay to all the guests, this hotel is also known for its great spa packages and will make your trip to Agra unforgettable.

Pavilion Heights

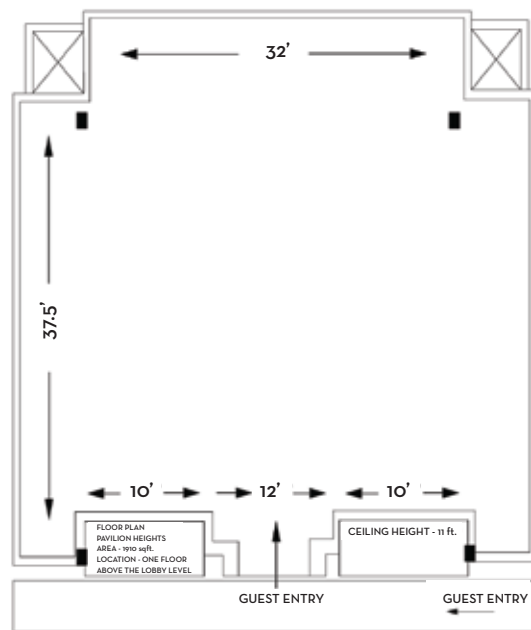

Pavilion of China

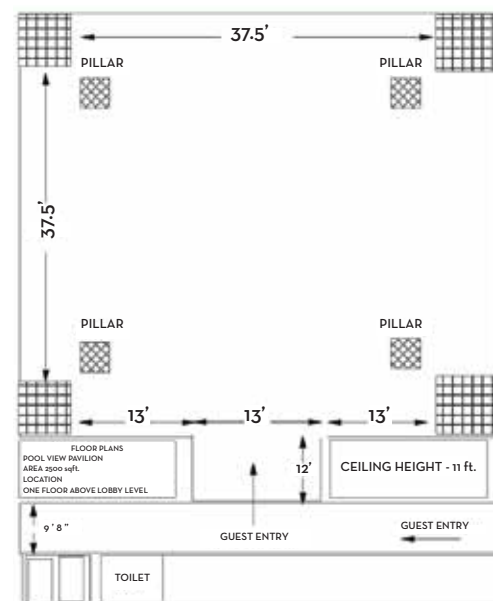

Swimming Pool



Agra Fort



Fatehpur Sikri



Ram Bagh

Places of Interest

The Taj Mahal

Taj Mahal is the Taj (crown) of India and is a sheer poetry in marble. Majestic, magnificent and unrivalled, the Taj Mahal is one of its kind across the world. The monument is a symbol of love, made by a great ruler for his beloved queen. It is an ultimate realization of Emperor Shahjahan's dream.

It is one of the 7 wonders of the world. From 1631 A.D., it took 22 years in its making. An estimated 20,000 people worked to complete the enchanting mausoleum, on the banks of the river Yamuna. For a breathtaking view of the Taj Mahal, one has to see it by moonlight.

Agra Fort

Near the gardens of Taj Mahal stands the important 16th-century Mughal monument known as the Red Fort of Agra. This powerful fortress of red sandstone encompasses within its 2.5-km-long enclosure walls in the imperial city of the Mughal rulers. The forbidding exteriors of this fort hide an inner paradise. There are a number of exquisite buildings like Moti Masjid - a white marble mosque akin to a perfect pearl; Diwan-e-Aam, Diwan-e-Khaas, Musamman Burj - where Mughal Emperor Shah Jahan died in 1666 A.D., Jahangir's Palace, Khaas Mahal and Sheesh Mahal. Agra Fort, an excellent example of Mughal architecture, is one of the few UNESCO World Heritage Sites in India.

Fatehpur Sikri

This royal city, Fatehpur Sikri, situated 26 miles west of Agra, Uttar Pradesh, was built under the orders of the great Mughal Emperor Akbar. In honour of Saint Shaikh Salim Chisti, Akbar founded a magnificent city on the Sikri ridge. The Buland-Darwaza was added some five years later. Among other important buildings are the tomb of Shaikh Salim Chishti, Naubat-or Naqqar Khana (drum-house), Taksal (mint), Karkhanas (royal workshop), Khazana (treasury), Hakim's quarters, Diwan-e-Aam (hall of public audience), house of Maryam also called Sunahra Makan (Golden House), palace of Jodh Bai, Birbal's house, etc.

Ram Bagh

It was created by Emperor Babar and is one of the earliest Mughal gardens. History says that Babar was temporarily buried here, before being interred at Kabul. The Persian influence can be well discerned in the layout of the garden that was designed in such a way as to resemble paradise in Islam.

Sur Sarovar (Keetham Lake)

Situated within Surdas Reserve Forest is a Scenic Lake, Sur Sarovar. It is a tranquil spot, ideal for relaxed outings. A wide variety of fishes and water birds add to the lake's natural charm and beauty.

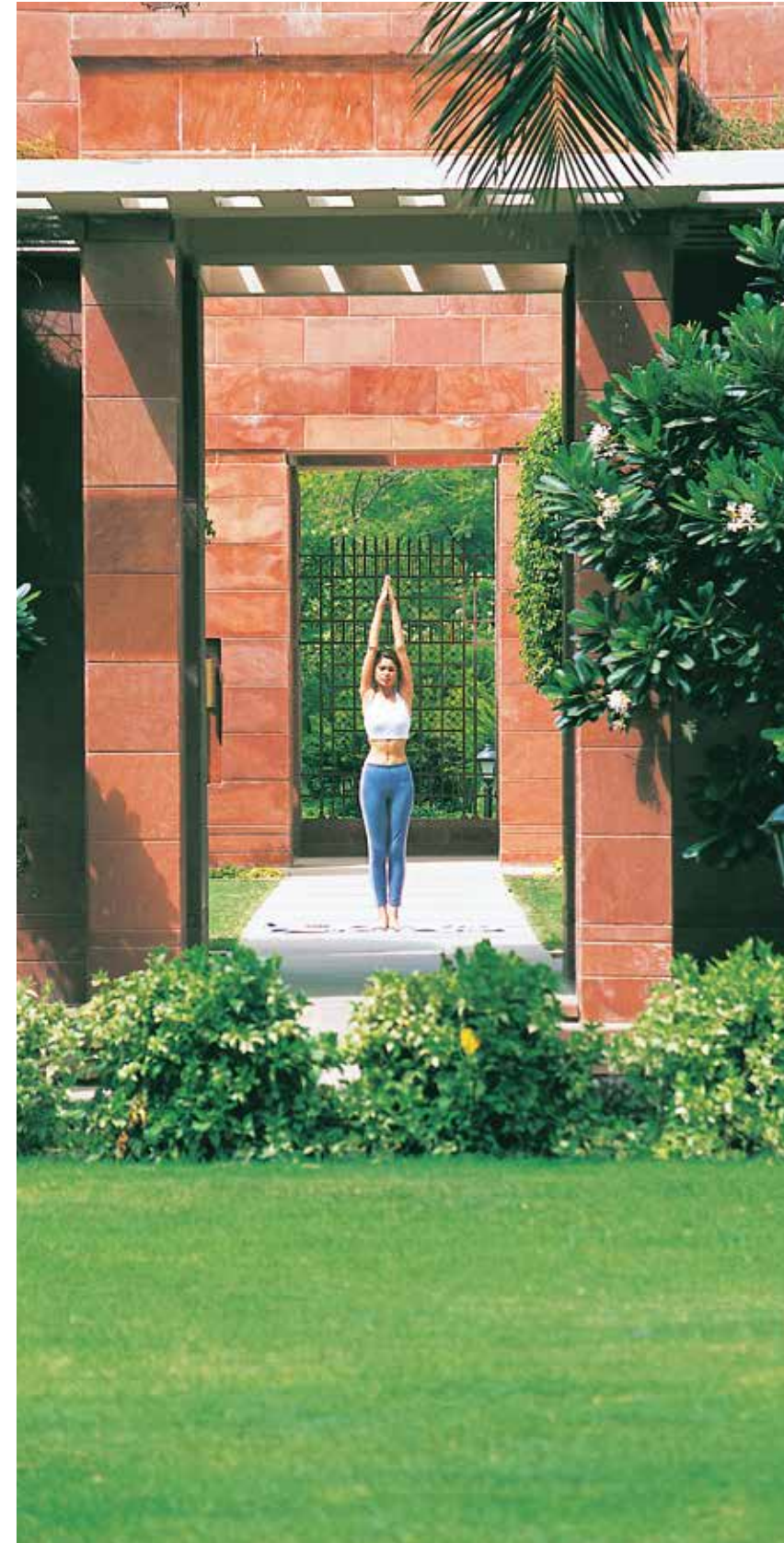

Sales & Reservations Offices

Hotels

NEW DELHI
JAYPEE VASANT CONTINENTAL
 Vasant Vihar New Delhi - 110057, India
 Tel:+91-11-26148800, 46008800 | Fax: +91-11-26148900
 reservations.jvc@jaypeehotels.com

JAYPEE SIDDHARTH
 3, Rajendra Place, New Delhi - 110008, India
 Tel:+91-11-25760000, 43662500 | Fax: +91-11-25781016
 reservations.jsd@jaypeehotels.com

GREATER NOIDA
JAYPEE GREENS GOLF & SPA RESORT
 Surajpur Kasna Road (near Pari Chowk)
 Greater Noida 201306 (U.P.), India
 Tel:+91-120-6743000, 2339900 | Fax:+91-120-2324700
 reservations.jggr@jaypeehotels.com

AGRA
JAYPEE PALACE HOTEL & CONVENTION CENTRE
 Fatehabad Road, Agra 282004, Uttar Pradesh, India
 Tel:+91-562-2330800, 6622700 | Fax:+91-562-2330850
 reservations.jpa@jaypeehotels.com

MUSSOORIE
JAYPEE RESIDENCY MANOR
 Barlowganj, Mussoorie 24812, India
 Tel:+91-135-2631800, 6602000 | Fax:+91-135-2631022
 reservations.jrm@jaypeehotels.com

Regional Sales Office

AHMEDABAD
 606 Sakar- V, Behind Natraj Cinema,
 Ashram Road, Ahmedabad-380 009, Gujarat, India
 Tel: +91-79-2658 4768 | Fax:+91-79-26586807
 ahm@jaypeehotels.com

BANGALORE
 Prestige Commercial Complex, 4th Floor, No 2 Church Street,
 Bangalore - 560001 | Karnataka, India
 Tel: +91-80-25591119 / 1120, 41521478 / 25591120
 bglr@jaypeehotels.com

CHANDIGARH
 Adarsh Mall, Plot No 30
 5th Floor, Industrial Area phase - II, New Tribune Chowk
 Chandigarh, 160035 | Punjab, India
 Tel:+91-172-6451699 | chan@jaypeehotels.com

CHENNAI
 No.24,(Old No.46), 2nd Floor.
 Dr.B.N.Road, (North Boag Road)
 T. Nagar, Chennai - 600 017 | Tamil Nadu, India
 Ph: 044 - 28150583 ; 044-28150584 | chen@jaypeehotels.com

HYDERABAD
 Door No. 8-2-120/76/1/B/14 & 15
 3rd Floor, Ashoka Hi-Tech Chamber, Road No. 2,
 Banjara Hills, Hyderabad - 500034
 Andhra Pradesh, India
 Mobile No: +91-9849976233 | rso.hyderabad@jaypeehotels.com

KOLKATA
 502, L & T Chambers,
 16, Camac Street, 5th Floor, Kolkata-700017, India
 Tel:+91-33-22810898 / 99 | Fax:+91-33-22895107
 | kol@jaypeehotels.com

LUDHIANA
 SCO, 137, Feroz Gandhi Market
 Near Stock Exchange, Ludhiana, Punjab, India
 Tel:+91-9216721918 | rso.ludhiana@jaypeehotels.com

MUMBAI
 106, Maker Chamber VI,
 10th Floor, Nariman Point, Mumbai-400 021, India
 Tel:+91-22-22826858 / 5121
 Fax:+91-22-22833585 | rso.mumbai@jaypeehotels.com